

DESCRIPTION: Ultrasonic Sensor
MODEL: MSW-G18200H09TR-W50

FEATURES

1. Dual Use: Transmitter and Receiver
2. Rugged sealed construction.
3. Cylindrical design allows for installation in various applications.
4. Short-range measurement capabilities.

APPLICATIONS

1. Level measurement
2. Automation control
3. Proximity
4. Obstacle avoidance
5. Robotics

SPECIFICATIONS

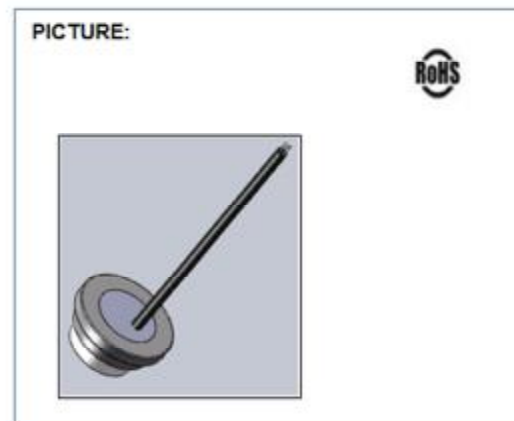

| Item | Value |
|----------------------------|--|
| Using method | Transmitter and Receiver |
| Center Frequency | 200± 15KHz(PV520A) |
| Capacitance | 500±30% pF(at 1.0KHz) |
| Directivity | 9±2°(-6dB) |
| Max.Input Voltage | 500Vp-p |
| Detectable range | 10-200cm |
| Ring time | ≤ 10cm (200Vp-p , 200KHz.) |
| Echo | ≥ 1.8V (test plate 100×100mm PVC, distance 20cm) |
| Distance of direction | 0.1 ~2m |
| Mean time between failures | 5000h |
| Protection class | IP67 |
| Housing material | Aluminum |
| Operating Temperature | -40~+80℃ |
| Storage Temperature | -40~+85℃ |

MECHANICAL DRAWING

units:mm

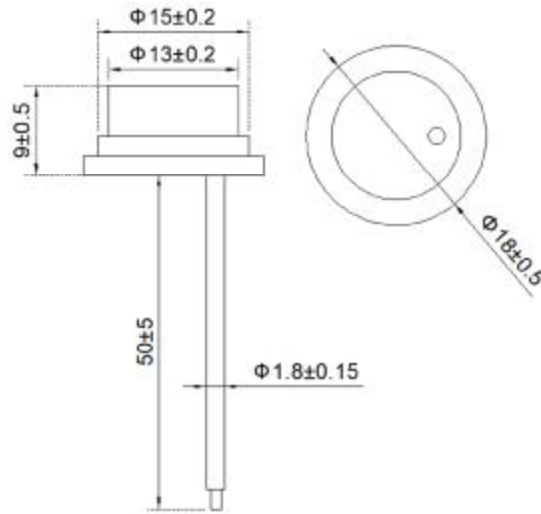

BEAM PATTERN

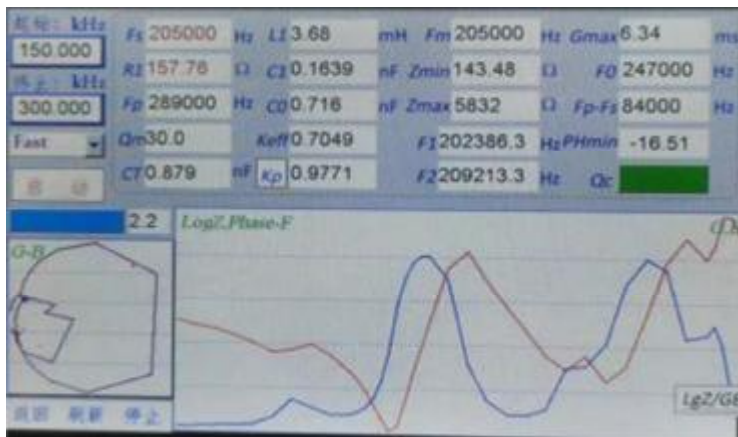

Frequency(kHz)

(发射电压: 200Vp-p; 周期: 50; 距离: 20cm)

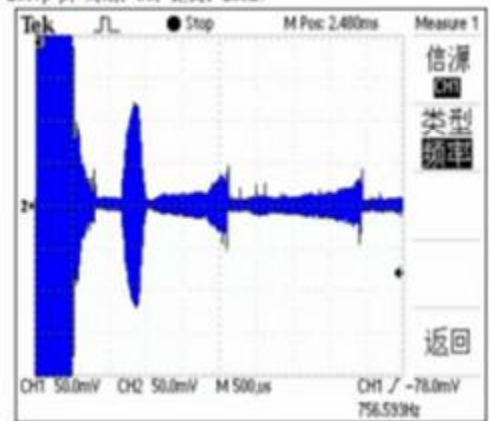

Sensitivity

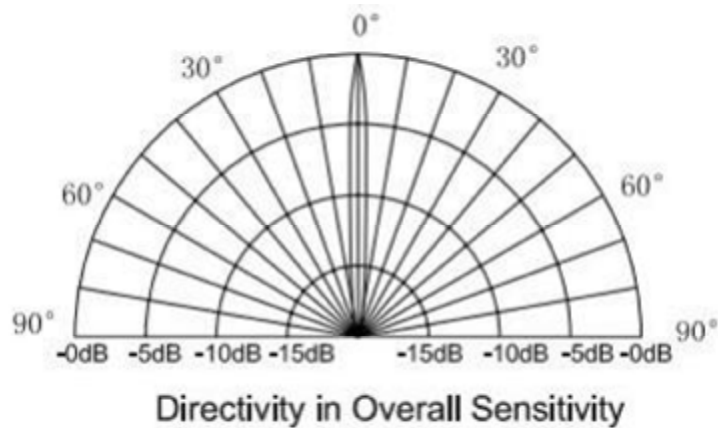

Directivity in Overall Sensitivity

PACKING

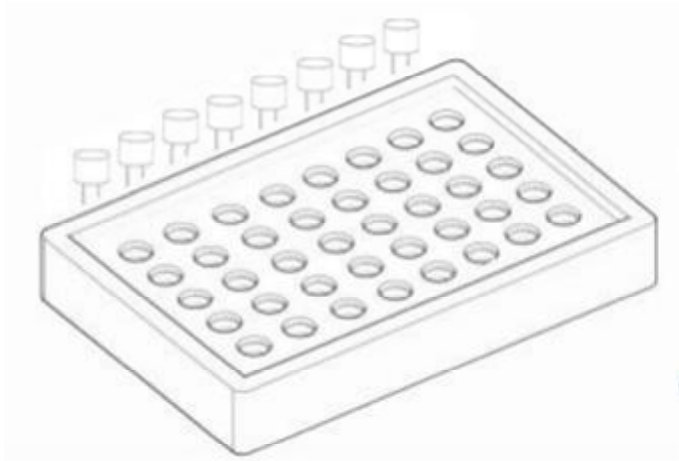

50PCS/BOX
BOX SIZE:23.5*13.5*3CM

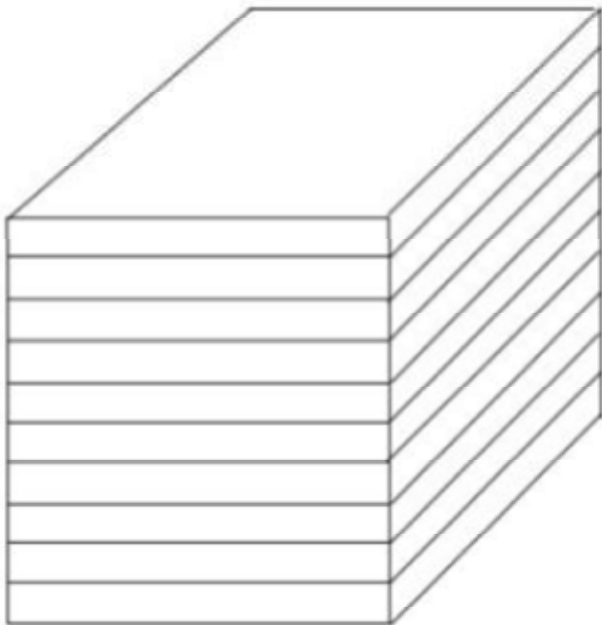

10BOXES/STACK, TOTAL 500PCS
STACK SIZE:23.5*13.5*31CM

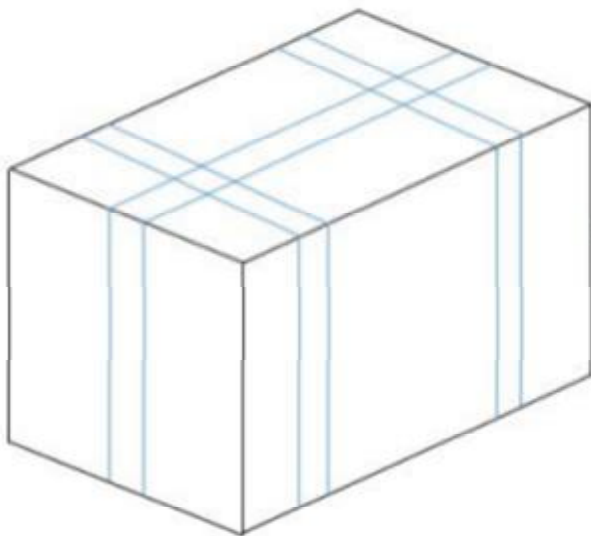

1000PCS/CARTON
CARTON SIZE:28*28.5*24CM